



32 Drumkeen Court, Upper Galwally Forestside, Belfast, BT8 7TU

Asking Price £159,950

A conveniently located two bedroom first floor apartment situated close to Forestside shopping centre in a quiet cul-de-sac. Drumkeen Court is a apartment development located in the ever so popular Upper Galwally area.

This generously sized property offers a spacious living area with separate fitted kitchen, two bedrooms and a shower room. This space is ideal for young professionals, Investors, or downsizers.

Externally, Drumkeen Court offers a private setting close to the Bustling Ormeau Road with private parking.

This property will appeal to many buyers, early viewing is recommended to avoid disappointment.

- An attractive first floor apartment
- Fitted kitchen with appliances
- Fully fitted shower suite
- Communal Parking To Front
- Excellent First Time Purchase
- Deceivingly spacious lounge
- Two good sized bedrooms
- Benefits from Gas Fired Central heating & Double Glazed Windows
- Ideal location to Forestside Shopping Centre

Energy Efficiency Rating		Current	Potential
(92-100) A	Very energy efficient - lower running costs		
(81-91) B			
(69-80) C			
(55-68) D		66	66
(39-54) E			
(21-38) F			
(1-20) G	Not energy efficient - higher running costs		

Northern Ireland
EU Directive 2002/91/EC

The Accommodation Comprises

Glass panelled pvc door to entrance

Stairs to First Floor

Large walk in storage area. Housing gas boiler.

Lounge 17'8 x 11'7 (5.38m x 3.53m)



Timber flooring. Spot-lights.



Fitted Kitchen 8'7 x 7'9 (2.62m x 2.36m)



Full range of high and low level units, Formica work surfaces, built in 4 ring hob and under oven, single drainer 1 1/4 bowl sink unit with mixer taps. Part tiled walls. Timber flooring.

Bedroom One 14'3 x 12'3 (4.34m x 3.73m)



Timber flooring. Lovely views out towards Cavehill.

Bedroom Two 10'4 x 6'5 (3.15m x 1.96m)



Double built in robe.

White Shower Room 6'7 x 5'9 (2.01m x 1.75m)



Comprising shower cubicle with chrome shower unit, pedestal wash hand basin with mixer taps, low flush w.c Part tiled walls. Tiled flooring. Heated chrome towel rail. Spot-lights.



Outside



Communal parking area to front.
Storage facility.

Floor Plan

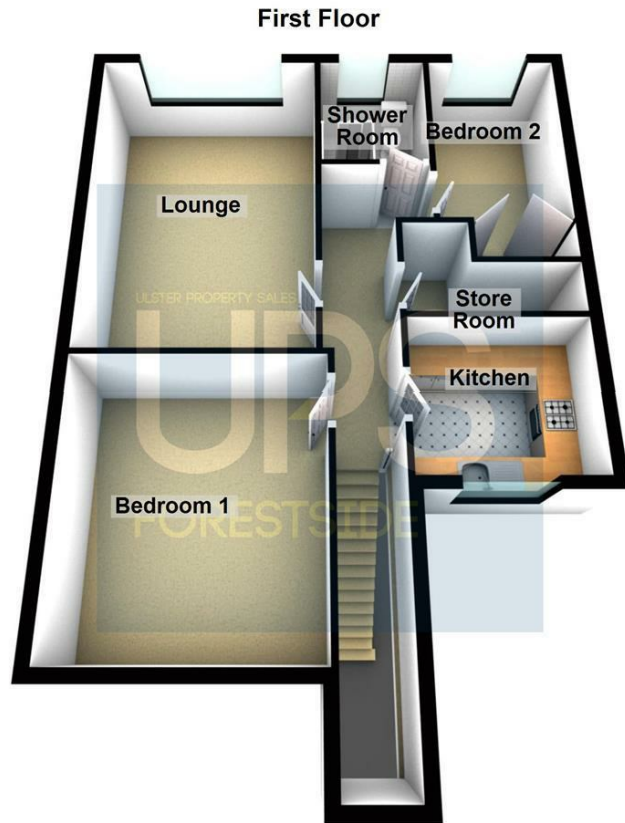

Please note this floor plan is for marketing purposes only, is not to scale and is to be used as a guide only. No liability is accepted in respect of any consequential loss arising from the use of this plan.
Plan produced using PlanUp.

Area Map

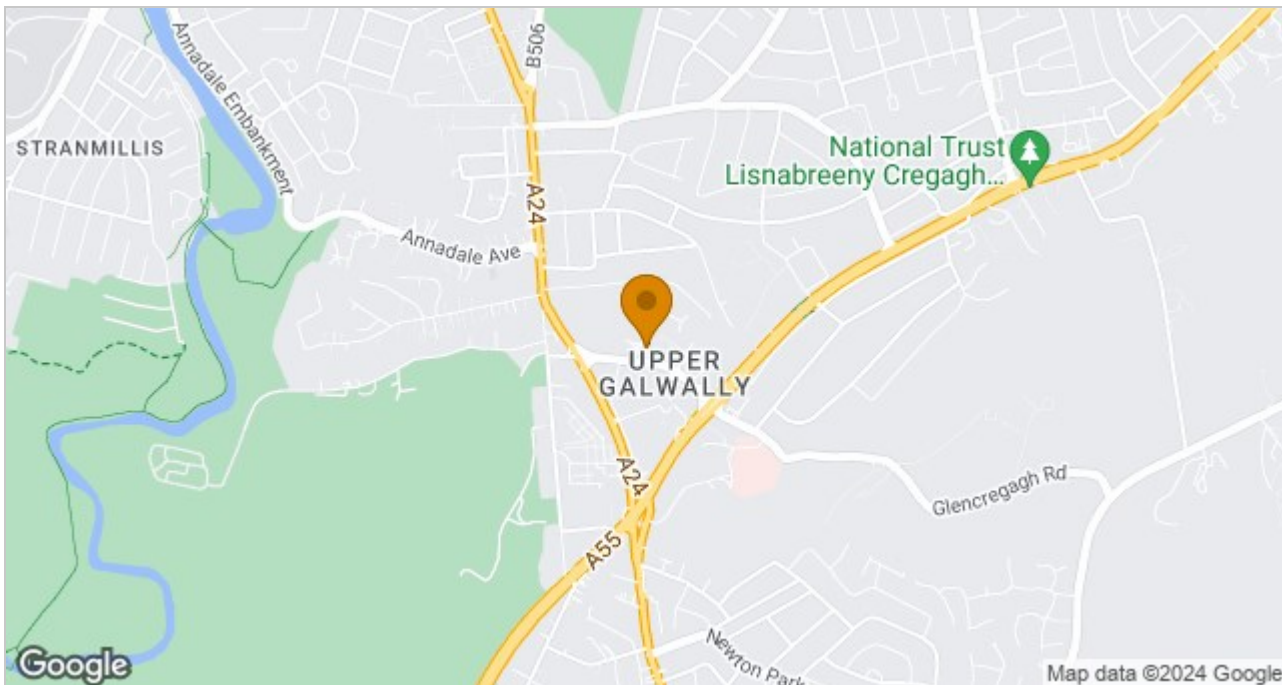

These particulars, whilst believed to be accurate are set out as a general outline only for guidance and do not constitute any part of an offer or contract. Intending purchasers should not rely on them as statements of representation of fact, but must satisfy themselves by inspection or otherwise as to their accuracy. No person in this firm's employment has the authority to make or give any representation or warranty in respect of the property.

ULSTERPROPERTYSALES.CO.UK

ANDERSONSTOWN
028 9060 5200

BALLYHACKAMORE
028 9047 1515

BALLYMENA
028 2565 7700

BALLYNAHINCH
028 9756 1155

BANGOR
028 9127 1185

CARRICKFERGUS
028 9336 5986

CAUSEWAY COAST
0800 644 4432

CAVEHILL
028 9072 9270

DOWNPATRICK
028 4461 4101

FORESTSIDE
028 9064 1264

GLENGORMLEY
028 9083 3295

MALONE
028 9066 1929

NEWTOWNARDS
028 9181 1444

RENTAL DIVISION
028 9070 1000

Forestsides Estates Ltd; Trading under licence as Ulster Property Sales (Forestsides) Reg. No. NI051121;
Registered Office: 9 Upper Crescent, Belfast BT7 1NT
©Ulster Property Sales is a Registered Trademark

