



## 19 BEECHFIELD AVENUE

Bangor BT19 7ZY

- 5 bedrooms ( 2 Ensuites )
- 3 Reception Rooms
- uPVC Double Glazing
- Oil Fired Heating System
- Maple Kitchen
- Bathroom / Shower Room
- Detached Garage
- Large Corner Site
- Flexible Accommodation
- Popular Location

Energy Efficiency Rating		Current	Potential
Very energy efficient - lower running costs			
(92 plus) <b>A</b>			
(81-91) <b>B</b>			
(69-80) <b>C</b>			
(55-68) <b>D</b>		55	63
(39-54) <b>E</b>			
(21-38) <b>F</b>			
(1-20) <b>G</b>			
Not energy efficient - higher running costs			
<b>Northern Ireland</b>		EU Directive 2002/91/EC	

**Offers Over £375,000**

# 19 Beechfield Avenue

, Bangor, BT19 7ZY



## ACCOMMODATION

uPVC double glazed entrance door into ...

## ENTRANCE HALL

Understairs storage cupboard. Built-in cloakscupboard. Laminated wood floor. 4 Downlights.

## WASH ROOM

Comprising: Vanity unit with inset wash hand basin and mixer taps. W.C. Anthracite heated towel rail.

## LOUNGE

18'11" into bay x 13'0" (5.77m into bay x 3.96m)  
15 Pane double doors. Open fireplace with gas fire, marble surround and hearth. 5 Downlights.

## KITCHEN

20'2" x 12'0" (6.15m x 3.66m)  
Range of maple high and low level cupboards and drawers with granite work surfaces. Built-in Neff stainless steel 5 ring gas hob and double oven. Extractor canopy with integrated fan and light. 11/2 tub single drainer sink unit with mixer taps. Integrated dishwasher. Plumbed for washing machine. 4 Downlights. Laminated wood floor.

## FAMILY ROOM

14'0" x 12'0" (4.27m x 3.66m)  
Laminated wood floor.

## DINING ROOM

12'4" x 10'5" (3.76m x 3.18m)  
Laminated wood floor. 3 Downlights.

## BEDROOM 4

14'0" x 12'4" (4.27m x 3.76m)  
Laminated wood floor.

## BEDROOM 5

13'0" x 10'0" (3.96m x 3.05m)

## SHOWER ROOM

Comprising: Walk-in shower with Thermostatic shower over with Drencher. Vanity unit with inset wash hand basin and mixer taps. W.C. Anthracite heated towel rail. 4 Downlights. Built-in extractor fan.

## STAIRS TO LANDING

2 Double built-in storage cupboards. Built-in hotpress.

## BEDROOM 1

18'5" x 11'9" (5.61m x 3.58m)

## ENSUITE

Comprising: Walk-in shower with Mira Sport electric shower. Vanity unit with inset wash hand basin and mixer taps. W.C. Anthracite heated towel rail. 2 Downlights. Built-in extractor fan.

## WALK-IN WARDROBE

## BEDROOM 2

16'10" x 12'7" (5.13m x 3.84m)  
3 Downlights.

## ENSUITE

Comprising: Walk-in shower with Mira Sport electric

shower. Vanity unit with inset wash hand basin and mixer taps. W.C. Anthracite heated towel rail. 3 Downlights. Built-in extractor fan.

## BEDROOM 3

12'8" x 8'8" (3.86m x 2.64m)  
2 Double glazed Velux windows.

## BATHROOM

White suite comprising: Panelled bath with mixer tap. Corner shower with Mira Vigour electric shower. Vanity unit with inset wash hand basin and mixer tap. W.C. Anthracite heated towel rail. 4 Downlights.

## OUTSIDE

## DETACHED GARAGE

20'11" x 12'0" (6.38m x 3.66m)  
Up and over door. Light and power. Oil fired boiler.

## FRONT & SIDE

Garden in lawn with trees and shrubs.

## REAR

Enclosed garden in lawn. Paved patio. Tap. Light. PVC oil tank.



## Directions





# Floor Plan

19 Beechfield Avenue, BANGOR, BT19 7ZY



Ground Floor

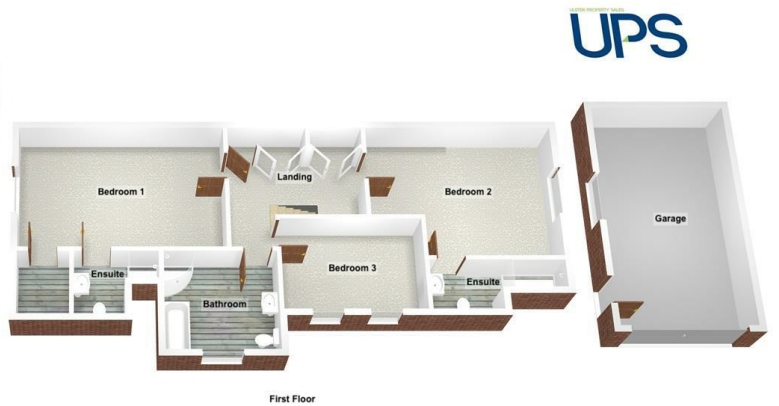

First Floor

Total Area: 207.8 m<sup>2</sup> ... 2236 ft<sup>2</sup> (excluding garage)  
All measurements are approximate and for display purposes only

These particulars, whilst believed to be accurate are set out as a general outline only for guidance and do not constitute any part of an offer or contract. Intending purchasers should not rely on them as statements of representation of fact, but must satisfy themselves by inspection or otherwise as to their accuracy. No person in this firm's employment has the authority to make or give any representation or warranty in respect of the property.

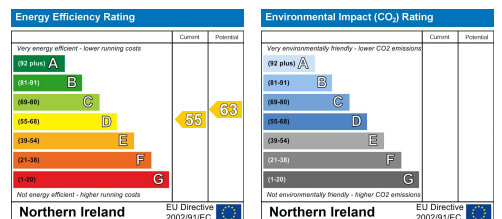

ULSTERPROPERTYSALES.CO.UK

**ANDERSONSTOWN**  
028 9060 5200  
**BALLYHACKAMORE**  
028 9047 1515  
**BALLYMENA**  
028 2565 7700

**BALLYNAHINCH**  
028 9756 1155  
**BANGOR**  
028 9127 1185  
**CARRICKFERGUS**  
028 9336 5986

**CAUSEWAY COAST**  
0800 644 4432  
**CAVEHILL**  
028 9072 9270  
**DOWNPATRICK**  
028 4461 4101

**FORETSIDE**  
028 9064 1264  
**GLENGORMLEY**  
028 9083 3295  
**MALONE**  
028 9066 1929

**NEWTOWNARDS**  
028 9181 1444  
**RENTAL DIVISION**  
028 9070 1000



Jonathan Collins trading under licence as Ulster Property Sales (North Down)  
©Ulster Property Sales is a Registered Trademark